

5520

4240

510

540

540

510

490

STRUTTURE PORTANTI REI 60:  
 P1: muri in c.a. sp. 20 cm  
 P3: pilastri in c.a. diam 45 cm  
 P9: solaio a lastre predalles  
 H=5+20+5=30 cm (B-C-E)

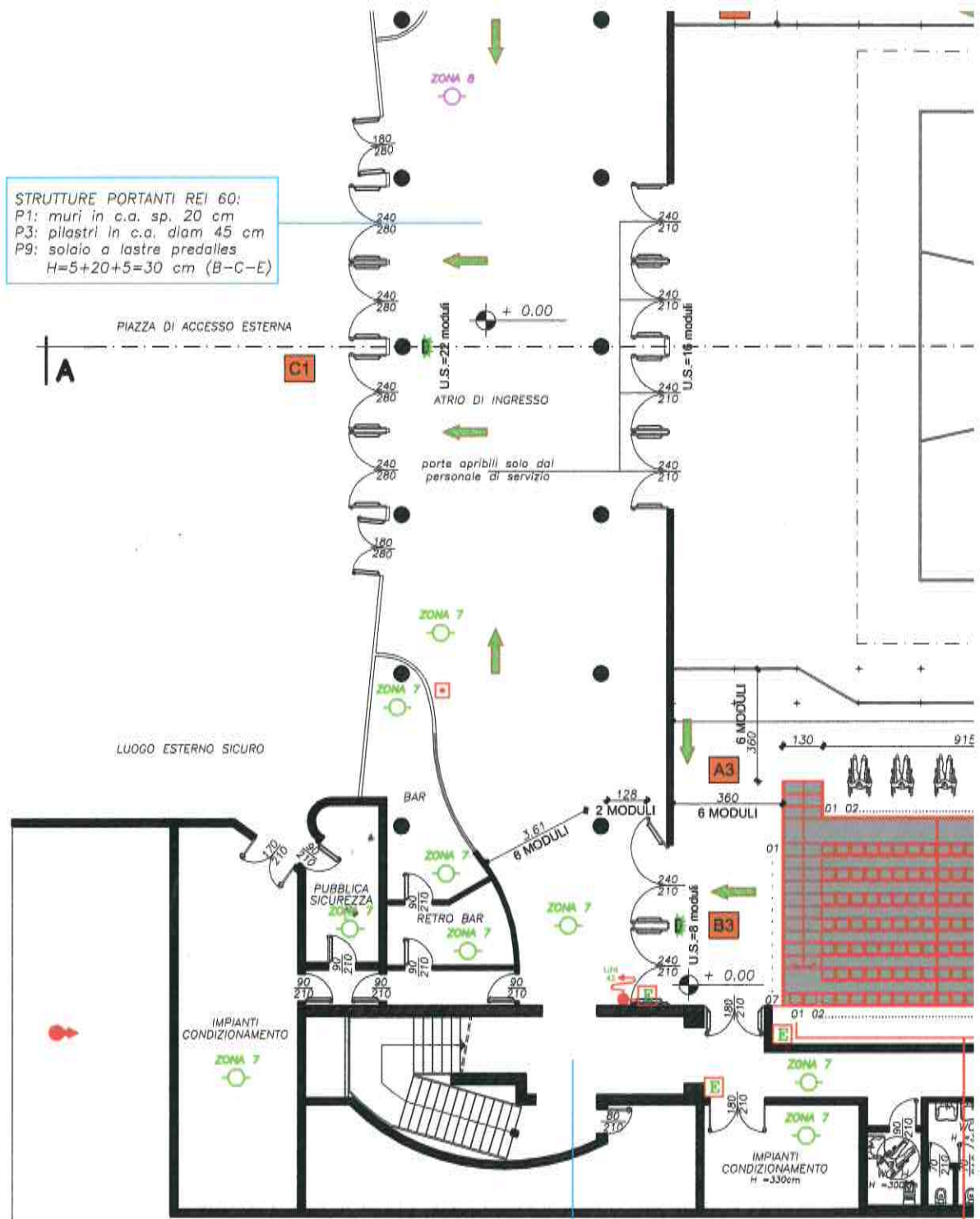

STRUTTURE PORTANTI REI 60:  
 P1: muri in c.a. sp. 30 cm  
 P1: muri in c.a. sp. 20 cm - scala in c.a.  
 P2: pilastri in c.a. 60x65 cm  
 P10: solaio H=22 cm

4  
 82  
 792  
 9  
 815

POST  
 6 FILEx20 POS  
 1 FILEx22 POS